



PRODUCT: BCS TIMEWATCH TWC

Product Overview

The TimeWatch TWC tenant override and billing system is a stand-alone unit which will interface to virtually any building control system marketed today. The TimeWatch provides complete override control through a voice-prompted telephone interface, which can be accessed from any touch-tone telephone. Time clock function provides time-of-day and holiday schedules for up to 248 individual loads.

The TWC system software compiles the stored override data for each tenant, and automatically generates an invoice for override usage, utilizing hourly rates set by the owner for each tenant.

The TimeWatch system gives both the tenant and building owner the best solution when tenant occupancy is required outside of the lease contract hours. The building owner will recover utility expenses for system operation, and the tenant will have complete access to schedule override times themselves.

The TimeWatch TWC is a stand-alone unit, and may be used in conjunction with third party EMS/BAS systems.

The TWC is accessed via a Windows graphics interface program, providing system setup and monitoring, along with comprehensive invoice preparation.



Features

- Touch-tone access to voice prompted system provides overrides in 1 hour increments.
- Over 9,000 possible security codes available, with 100 active on any given application.
- Programmable custom voice messages allow operators to personalize each individual building system.
- Stand-alone operation or complete interaction with building automation systems.
- Time scheduling for on/off control of up to 248 individual loads.
- 15 daily control schedules with special and holiday times.
- Automatic tracking of override usage by tenant security code.
- Records date, time and duration of all overrides.
- Full invoice preparation based on rates determined by the site manager for tenant.
- Windows based installation and setup interface.
- Direct connection of on-site personal computer through RS232 port.
- Remote communications through on-board telephone modem allows off-site programming and interrogation of the system, including full data retrieval.
- Requires a minimum of one (1) RBS eight output board for connection to loads or third party system.
- Program integrity provided by battery backed-up RAM which retains system operational program regardless of power conditions for up to 5 years.
- Total system configuration of thirty-one (31) RBS controllers, providing a total point capacity of 248 individual loads.
- Daisy chain wiring configuration to output boards.
- Controller network communication bus length of up to 4000 feet.
- 120vac power

Controller Details

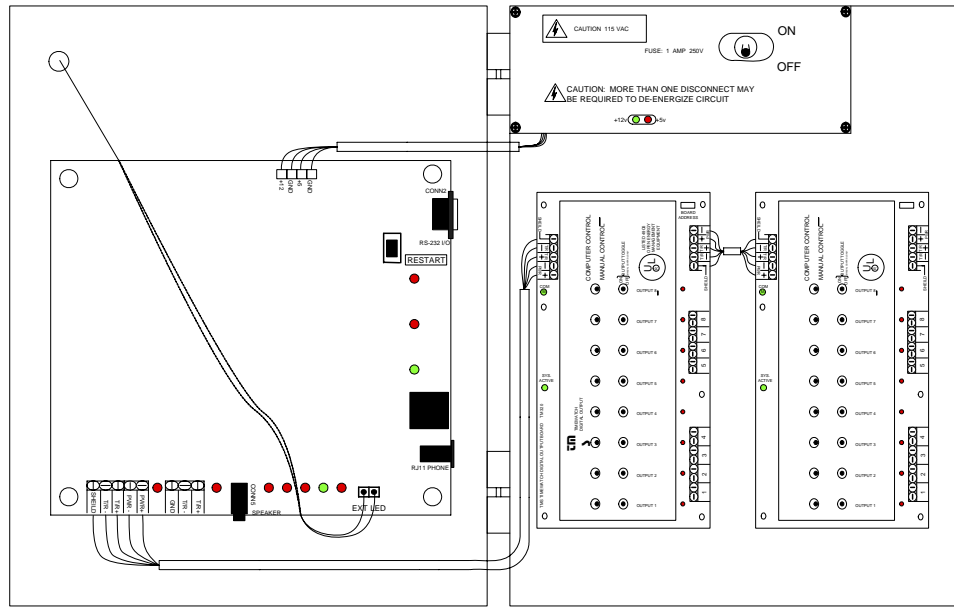

View of open TimeWatch TWC Override Controller with 2 RSB Boards

Specifications

UL Listing:	ANSI/UL 916
Temperature:	32° to 125° fahrenheit
Humidity:	95% non-condensing
Input Power:	Voltage: 115vac (-15% / +10%) 60hz Current: 0.2 amp maximum
Ports:	RS-485 output board comm RS-485 Aux illiary comm RS-232 Direct connect comm RS-232 RJ-11 Modem
Enclosure:	Nema 1 with thumbscrews
Dimensions:	14.2h x 14.0w x 3.5d
Weight:	13.0 lbs.

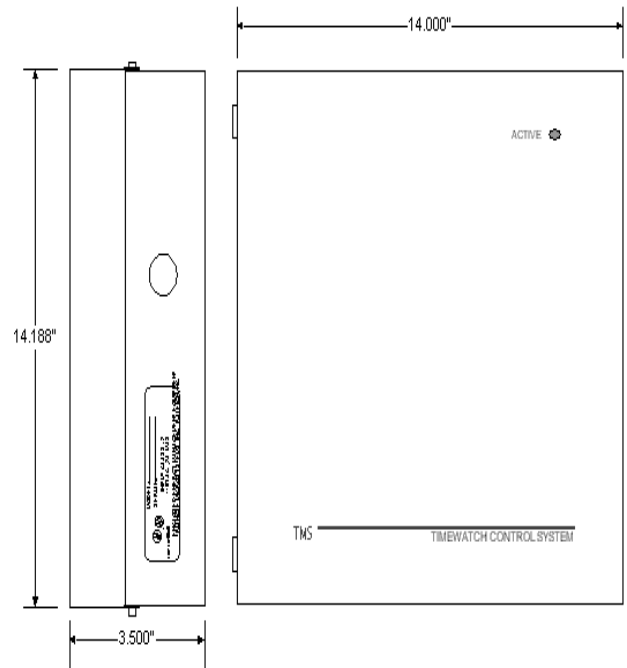

Although accurate at the time of publication, data is subject to change without notice